

## ASP – 52/56 Cartridge Seal



### Product Description

The Type 52/56 is a Multiple Spring, Self-Aligning, 'O'-Ring Mounted, 4-Bolt Gland Cartridge Mechanical Seal.

- Cost-effective alternative to replace Mechanical Seals commonly found in industrial, public utility and marine applications.

Available in:

- Type 52B: Plain Gland
- Type 56B: Tangential Flush, Quench and Drain Gland

- All components interchangeable between Types 52B/56B and 55B.

- Flush port sizes: 1/4" NPT

### Material Options

#### Rotary Face

Sintered Silicon Carbide  
M825 Carbon  
Tungsten Carbide

#### Stationary Face

Reaction Bonded Silicon Carbide  
Tungsten Carbide

#### Elastomers

Viton® (as standard) / Aflas® / EP / Nitrile / Kalrez

#### Springs

Hastelloy C

#### Metal parts

316 Stainless Steel

### Features Summary

- 4-Bolt Gland design for nearly all universal fittings
- Self-Aligning Stationary faces
- Easy installation greatly minimising fitting errors
- Hydraulically-balanced faces
- Minimal internal and external protrusion
- Non-Clogging seal faces and springs
- Non-Shaft fretting
- Carbon vs Silicon Carbide Seal Faces providing 3x higher pV values compared to Carbon vs Ceramic
- Available **Stock**

### Performance Capabilities

- Temperature: -30°C to +150°C

- Pressure: Up to 30 bar (435 psi)

**Important:** Performance information given is dependent

on materials and other operating conditions.



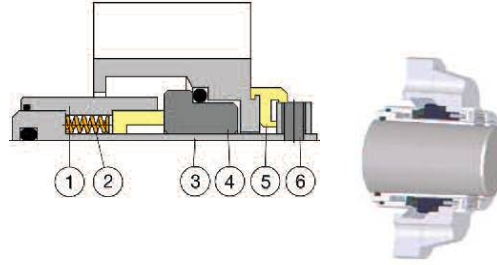
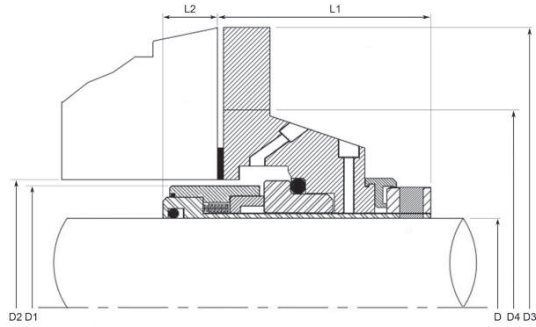

1	Rotary Retainer	4	Stationary Face
2	Springs	5	Centering Spacer
3	Sleeve	6	Clamp Ring

## Dimensional Data

D		D1 Rotary OD		D2 (S/B ID) Min		D2 (S/B ID) Max		D3 Gland OD		D4 Slot to Slot		L1 Ext W/L		L2 Int W/L		Slot Width	
Inches	mm	Inches	mm	Inches	mm	Inches	mm	Inches	mm	Inches	mm	Inches	mm	Inches	mm	Inches	mm
1.000	25	1.66	42.30	1.73	44.00	1.89	48.00	3.86	98.00	2.34	59.5	1.83	46.40	0.46	11.80	0.51	13.00
	28	1.81	46.00	1.87	47.50	2.01	51.00	3.86	98.00	2.56	65.0	1.83	46.40	0.46	11.80	0.51	13.00
1.125	30	1.81	46.00	1.87	47.50	2.01	51.00	3.86	98.00	2.56	65.0	1.83	46.40	0.46	11.80	0.51	13.00
	32	1.92	48.90	1.97	50.00	2.17	55.00	4.25	108.00	2.56	65.0	1.83	46.40	0.48	12.30	0.51	13.00
1.250	32	1.92	48.90	1.97	50.00	2.17	55.00	4.25	108.00	2.91	74.0	1.83	46.40	0.48	12.30	0.51	13.00
	33	2.07	52.80	2.12	53.90	2.30	58.50	4.25	108.00	2.91	74.0	1.83	46.40	0.52	13.30	0.51	13.00
1.375	35	2.07	52.80	2.12	53.90	2.30	58.50	4.25	108.00	2.91	74.0	1.83	46.40	0.52	13.30	0.51	13.00
	38	2.20	56.00	2.25	57.15	2.44	62.00	4.63	117.50	2.91	74.0	1.83	46.40	0.54	13.80	0.51	13.00
1.500	40	2.20	56.00	2.25	57.15	2.44	62.00	4.63	117.50	2.91	74.0	1.83	46.40	0.54	13.80	0.51	13.00
	42	2.33	59.20	2.37	60.30	2.60	66.00	4.63	117.50	3.09	78.5	1.83	46.40	0.54	13.80	0.51	13.00
1.625	43	2.33	59.20	2.37	60.30	2.60	66.00	4.63	117.50	3.09	78.5	1.83	46.40	0.54	13.80	0.51	13.00
	44	2.45	62.40	2.50	63.50	2.91	74.00	5.26	133.50	3.35	85.0	1.83	46.40	0.54	13.80	0.51	13.00
1.750	44	2.45	62.40	2.50	63.50	2.91	74.00	5.26	133.50	3.35	85.0	1.83	46.40	0.54	13.80	0.51	13.00
	45	2.45	62.40	2.50	63.50	2.91	74.00	5.26	133.50	3.35	85.0	1.83	46.40	0.54	13.80	0.51	13.00
1.875	48	2.59	65.80	2.62	66.67	2.91	74.00	5.26	133.50	3.39	86.0	1.83	46.40	0.62	15.80	0.63	16.00
	50	2.59	65.80	2.62	66.67	2.91	74.00	5.26	133.50	3.39	86.0	1.83	46.40	0.62	15.80	0.63	16.00
2.000	50	2.70	68.80	2.75	69.85	3.11	79.00	5.89	149.50	3.78	96.0	1.94	49.40	0.50	12.80	0.63	16.00
	55	2.70	68.80	2.75	69.85	3.11	79.00	5.89	149.50	3.78	96.0	1.94	49.40	0.50	12.80	0.63	16.00
2.125	55	2.83	71.90	2.87	73.02	3.25	82.55	5.89	149.50	3.88	98.5	1.94	49.40	0.50	12.80	0.63	16.00
	60	2.96	75.20	3.01	76.50	3.37	85.72	5.89	149.50	3.88	98.5	1.94	49.40	0.50	12.80	0.63	16.00
2.250	60	2.96	75.20	3.01	76.50	3.37	85.72	5.89	149.50	3.88	98.5	1.94	49.40	0.50	12.80	0.63	16.00
	63	3.08	78.30	3.12	79.37	3.50	88.90	6.38	162.00	3.90	99.0	2.03	51.50	0.45	11.50	0.63	16.00
2.375	63	3.08	78.30	3.12	79.37	3.50	88.90	6.38	162.00	3.90	99.0	2.03	51.50	0.45	11.50	0.63	16.00
	65	3.31	84.20	3.37	86.72	3.63	92.25	6.75	171.50	3.90	99.0	2.13	54.00	0.50	12.80	0.63	16.00
2.500	65	3.31	84.20	3.37	86.72	3.63	92.25	6.75	171.50	3.90	99.0	2.13	54.00	0.50	12.80	0.63	16.00
	70	3.44	87.40	3.50	88.90	3.87	98.42	6.75	171.50	4.50	114.3	2.13	54.00	0.57	14.60	0.63	16.00
2.625*	70	3.44	87.40	3.50	88.90	3.87	98.42	6.75	171.50	4.50	114.3	2.13	54.00	0.57	14.60	0.63	16.00
	75	3.56	90.60	3.62	92.07	3.87	98.42	6.75	171.50	4.50	114.3	2.13	54.00	0.57	14.60	0.63	16.00
2.750*	75	3.56	90.60	3.62	92.07	3.87	98.42	6.75	171.50	4.50	114.3	2.13	54.00	0.57	14.60	0.63	16.00
	80	3.81	96.90	3.88	98.43	4.50	114.30	7.38	187.50	5.04	128.0	2.13	54.00	0.59	15.00	0.63	16.00
3.000*	80	3.81	96.90	3.88	98.43	4.50	114.30	7.38	187.50	5.04	128.0	2.13	54.00	0.59	15.00	0.63	16.00
	85	3.93	100.00	4.00	101.60	4.50	114.30	7.38	187.50	5.08	129.0	2.13	54.00	0.63	16.00	0.79	20.00
3.125*	85	3.93	100.00	4.00	101.60	4.50	114.30	7.38	187.50	5.08	129.0	2.13	54.00	0.63	16.00	0.79	20.00
	90	4.06	103.30	4.13	104.78	4.62	117.47	7.87	200.00	5.08	129.0	2.13	54.00	0.63	16.00	0.79	20.00
3.250*	90	4.06	103.30	4.13	104.78	4.62	117.47	7.87	200.00	5.08	129.0	2.13	54.00	0.63	16.00	0.79	20.00
	95	4.18	106.40	4.25	107.96	4.75	120.65	7.87	200.00	5.39	137.0	2.13	54.00	0.63	16.00	0.79	20.00
3.375*	95	4.18	106.40	4.25	107.96	4.75	120.65	7.87	200.00	5.39	137.0	2.13	54.00	0.63	16.00	0.79	20.00
	100	4.31	109.60	4.38	111.13	4.75	120.65	7.87	200.00	5.79	147.0	2.13	54.00	0.63	16.00	0.79	20.00
3.500*	100	4.31	109.60	4.38	111.13	4.75	120.65	7.87	200.00	5.79	147.0	2.13	54.00	0.63	16.00	0.79	20.00
	105	4.44	112.80	4.50	114.30	5.25	133.40	7.87	200.00	5.79	147.0	2.13	54.00	0.63	16.00	0.79	20.00
3.625*	105	4.44	112.80	4.50	114.30	5.25	133.40	7.87	200.00	5.79	147.0	2.13	54.00	0.63	16.00	0.79	20.00
	110	4.56	116.00	4.63	117.48	5.37	136.52	8.39	213.00	5.87	149.0	2.13	54.00	0.63	16.00	0.79	20.00
3.750*	110	4.56	116.00	4.63	117.48	5.37	136.52	8.39	213.00	5.87	149.0	2.13	54.00	0.63	16.00	0.79	20.00
	115	4.56	116.00	4.63	117.48	5.37	136.52	8.39	213.00	5.87	149.0	2.13	54.00	0.63	16.00	0.79	20.00
4.000*	115	4.56	116.00	4.63	117.48	5.37	136.52	8.39	213.00	5.87	149.0	2.13	54.00	0.63	16.00	0.79	20.00
	120	4.94	125.60	5.13	130.18	5.75	146.05	9.27	235.50	6.22	158.0	2.24	57.00	0.43	10.80	0.79	20.00
4.000*	120	4.94	125.60	5.13	130.18	5.75	146.05	9.27	235.50	6.22	158.0	2.24	57.00	0.43	10.80	0.79	20.00